

SCREW CONVEYOR

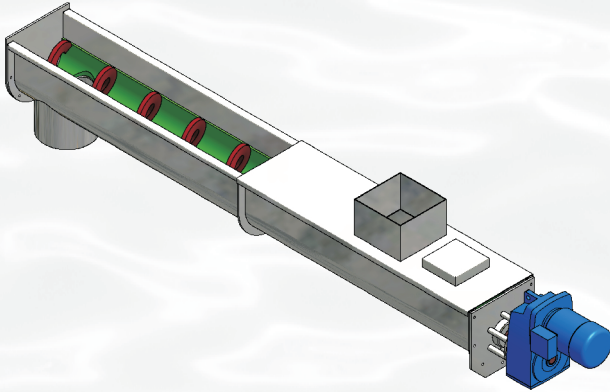

APPLICATION

The screw conveyor is a mechanical facility designed to convey dewatered sludge and any bulk material of similar composition. It is primarily designed to be installed at WWTP.

The screw conveyor can be used separately or together with other conveyors connected to each other, for example to transport sludge from the dewatering centrifuge to a sludge storage site.

ADVANTAGES

- Enclosed design
- Simple structure
- Easy maintenance
- Automatic operation
- Customized design

CONVEYOR DESIGN

Screw conveyors are available in different materials, conveyor body and conveying screw versions. The conveyor materials are either class 11 steel or stainless steel. The conveyor body can be either of a tube or a trough design. The conveying screws are available either in the shaft or staffless design.

The screw conveyor consists of a conveyor drive, body and accessories. The conveyor drive is usually designed with a flat spur gearbox and an asynchronous motor. The gearbox is situated on a shaft sealed in the conveyor body by means of a stuffing box. The conveyor body comprises a casing housing a conveyor screw and lining. As a standard, the conveyor casing has one feeding hopper, a discharging chute and a supporting frame. To meet the purpose, the conveyor can be supplied with accessories.

MATERIALS

Conveyor body	Class 11 steel, hot-dip galvanized according to ČSN EN ISO 1461 Stainless steel
Lining	Class 12 steel Plastic UHMW-PE
Conveyor screw	St 52-3 steel, priming coat Stainless steel

ACCESSORIES

- Thermal insulation with heating
- Material feeding hoppers and discharging chutes
- Flushing inlets
- Drain outlet
- Sight glass
- Central bearing with travel
- Longitudinal travel over sludge storage
- Electrically or manually controlled closable discharge

Czech Republic:

K&K TECHNOLOGY a.s.,
Zlatnická 33, 339 01 Klatovy
Tel: +420 376 356 111, Fax: +420 376 322 771, E-mail: kk@kk-technology.cz
<http://www.kk-technology.cz>

Slovak Republic:

K&K TECHNOLOGY a.s.,
Nám. SNP 90, 976 13 Slovenská Ľupča
Tel: +421 484 723 100, Fax: +421 484 723 188, E-mail: kk@kk-technology.sk
<http://www.kk-technology.sk>

SCREW CONVEYOR

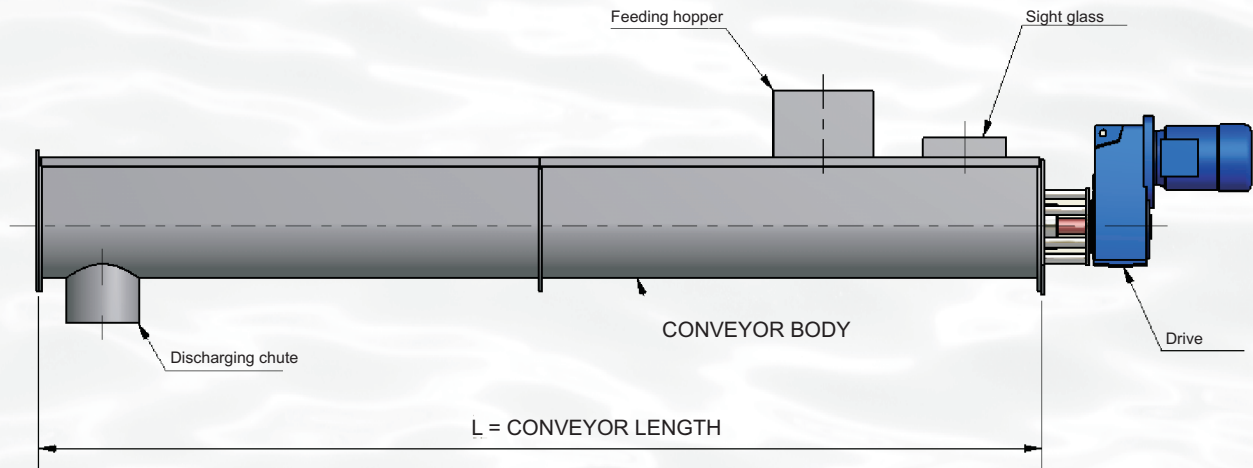

TECHNICAL PARAMETERS

- Capacity up to 16 m³/h
- Conveyor length
 - o Shaft screw up to 6 m
 - o Shaftless screw up to 24 m
- Nominal dimensions of conveyor trough: 250, 260, 320, 350, 420, 500, 600.
- Conveyor gradient 0° to 30°, 90°.
- Unit power input from 0,6 kW up to 12 kW.

Screw layout:

The screw conveyor is always designed according to the customer requirements to meet the specific purpose. The enquiry should specify the basic parameters, i.e. the material to be transported, power, conveyor length and gradient, location, and operating temperature. It is advisable to add a simple sketch to the enquiry. We would recommend suitable accessories with the conveyor design, e.g. an automatic-controlled heating cable under the thermal insulation, a flushing inlet, a sight glass, etc.

Czech Republic:

K&K TECHNOLOGY a.s.,
Zlatnická 33, 339 01 Klatovy
Tel: +420 376 356 111, Fax: +420 376 322 771, E-mail: kk@kk-technology.cz
<http://www.kk-technology.cz>

Slovak Republic:

K&K TECHNOLOGY a.s.,
Nám. SNP 90, 976 13 Slovenská Ľupča
Tel: +421 484 723 100, Fax: +421 484 723 188, E-mail: kk@kk-technology.sk
<http://www.kk-technology.sk>